

# UNIMOKE MINITRAILER

## VERSION 1: SIMPLE-TRAILER

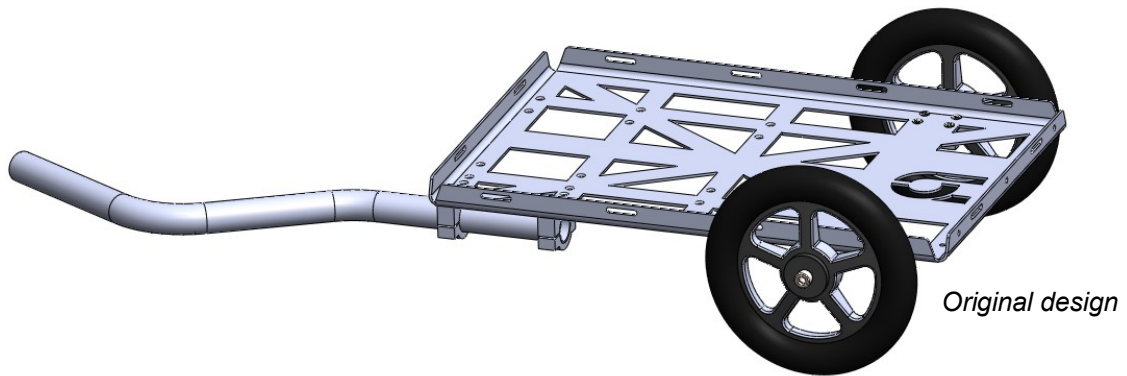

## VERSION 2: FOLDABLE-TRAILER

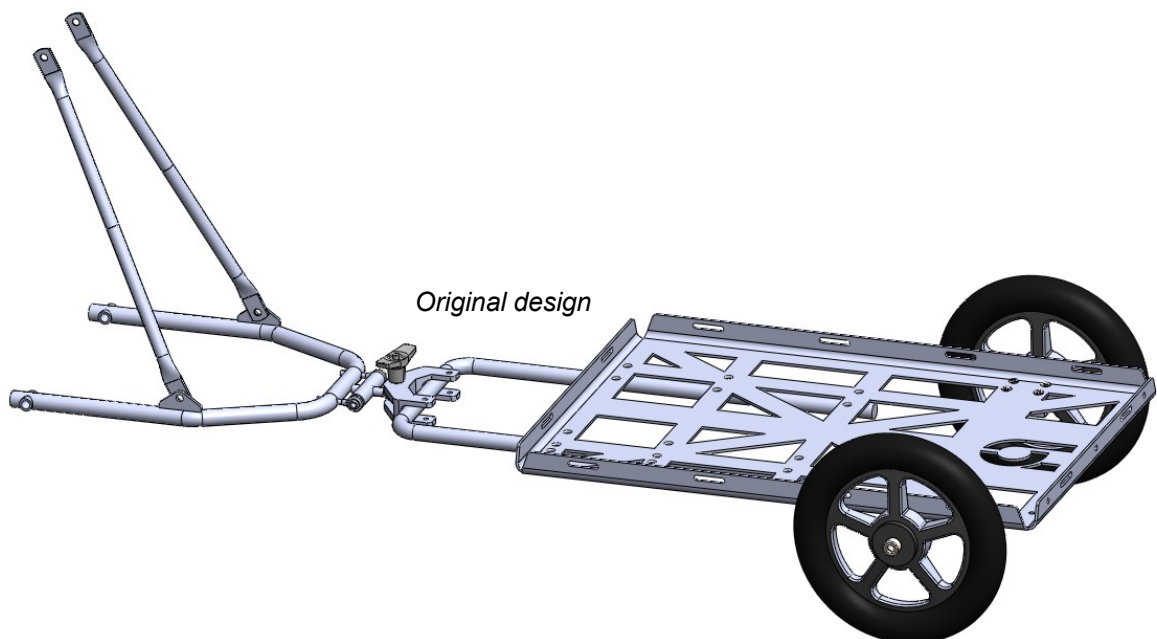

# 1. TRAILER

- Black anodized 3mm aluminium sheet trailer flat box (water/laser/CNC cut and bent).
- Black anodized aluminium blocks for wheel shaft.
- Stainless steel screws and autolock nuts.
- 10X2 inch plastic wheel with bearings, 50km/h rated speed, 40kg rated load each. To be detailed/sourced by SEIC

## MODIFICATIONS

- **Countersink holes for almost flat surface when putting DIN7991 screws**
- For next batches use 4mm aluminium

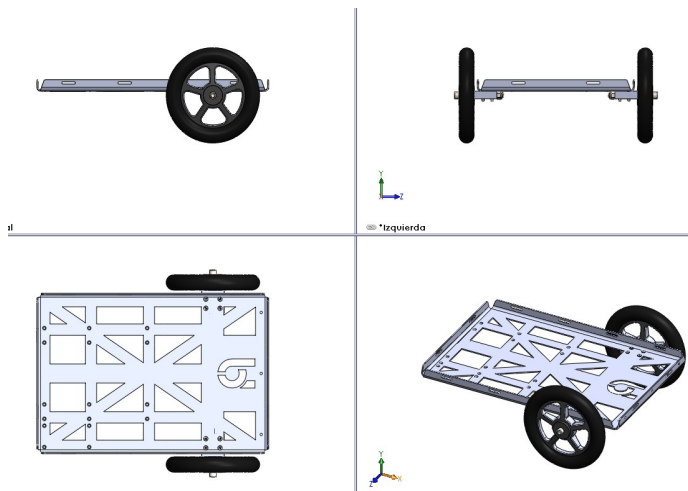

# 2. SIMPLE-TRAILER SUPPORT

## Original instructions

- Bent aluminium tube.
- Black anodized aluminium blocks/brackets CNC machined.
- Stainless steel screws and autolock nuts.

## MODIFICATIONS

- **Already done: butt 100mm length to 30.5mm O.D.**
- **Drill 6mm diameter hole 25mm from the edge**

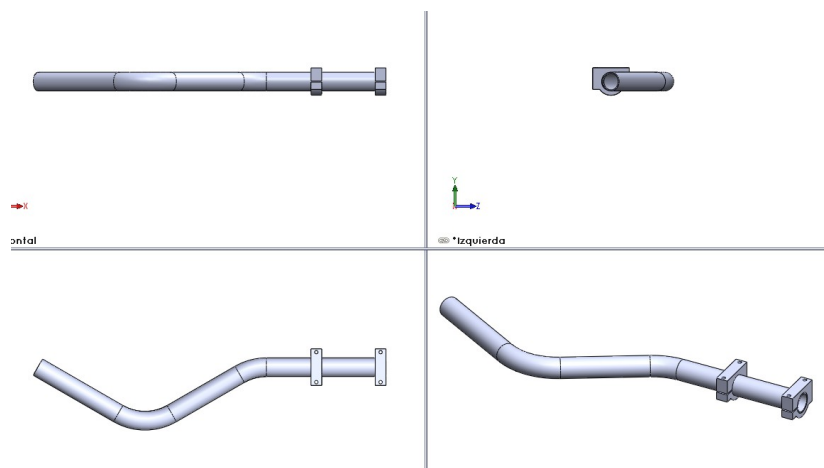

### 3. FOLDABLE TRAILER SUPPORT

#### 3.1 MAIN SUPPORT

##### CHECK

- Square piece blocks the wheel



##### MODIFICATIONS

- Square block have to be welded towards the rear, and need a hole for a security M4 fixation screw.

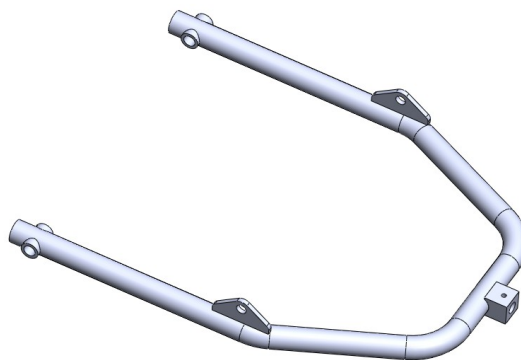

## 3.2 REINFORCING STRUTS

### CHECK

- Holes too small
- Upper hole will not fit even if it is 8mm
- Pieces don't lay flat on the brackets (angle of bend too big)

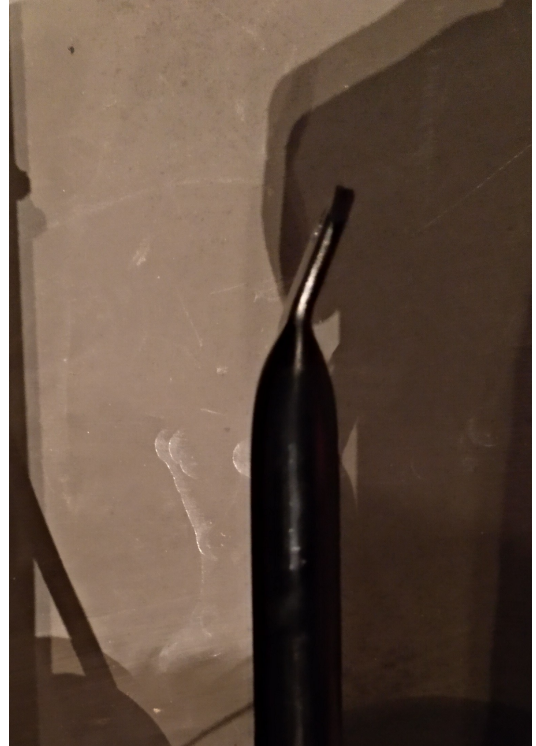

### MODIFICATIONS

- Change hole to 10mm diameter in both ends
- Re-bend to appropriate angle

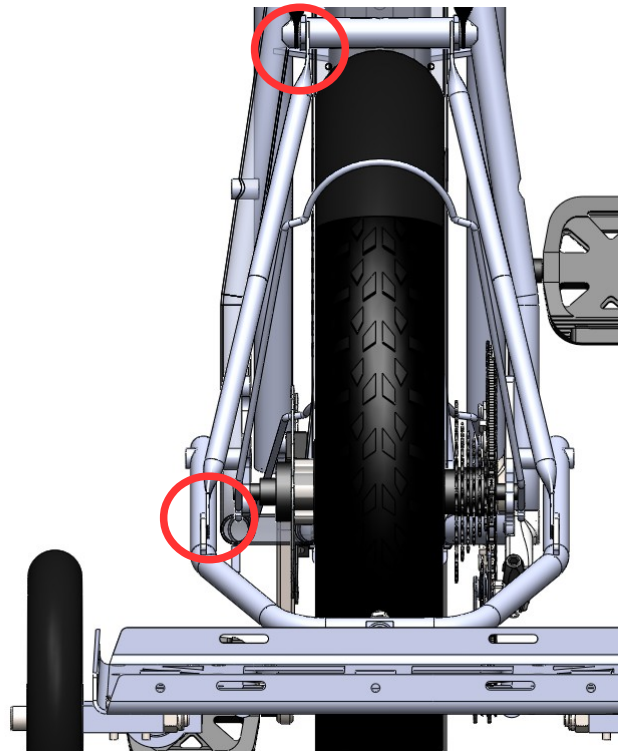

### 3.3 UNIVERSAL JOINT

#### CHECK

- Angle of bend not enough for folding up (they are only 90°)
- Need additional holes for fix to the structure (for security added to the nut) and to the trailer

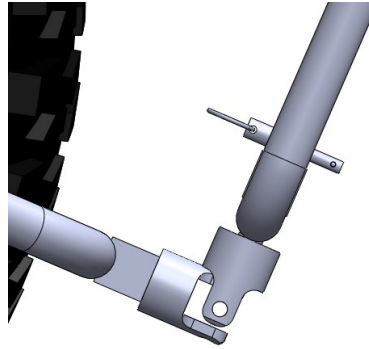

#### MODIFICATIONS

- Make longer pieces for the joint (9mm longer each) to allow for greater bend angle (1)
- Add 4mm hole in the support side (fitting the 4mm hole in the square block of the support) (2)
- Add 5mm hole in the trailer handle side (3)
- Add a 5mm ball lock pin to fix the joint to the trailer. (4)

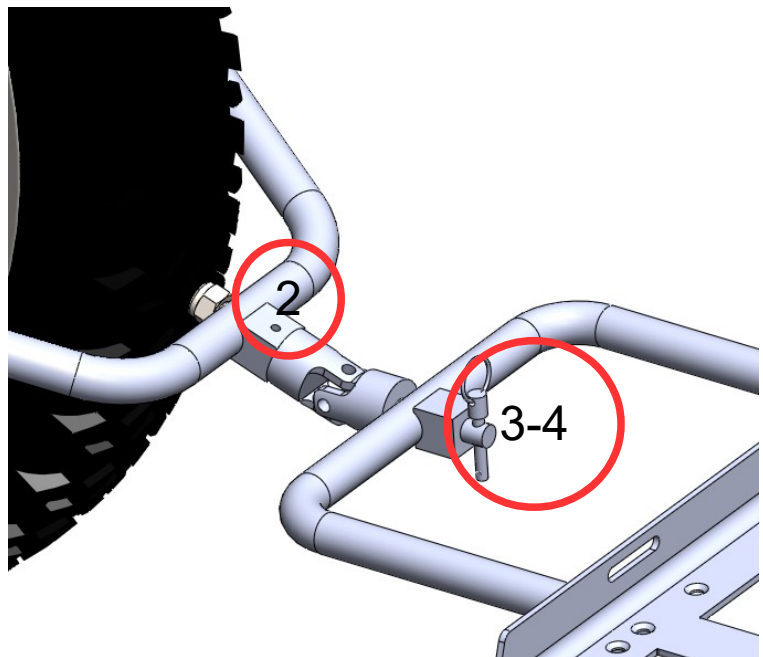
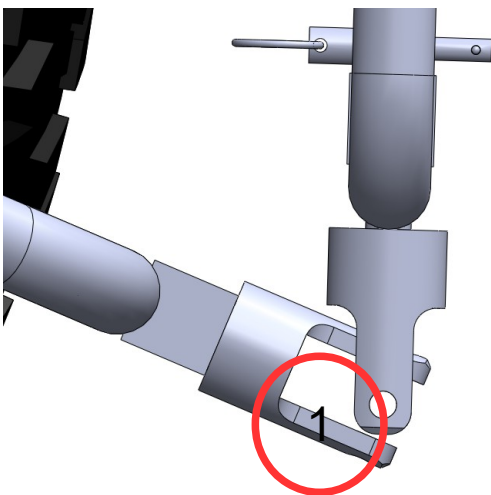

## 3.4 TRAILER HANDLE

### CHECK

- Missing fixing blocks for the trailer
- Necessary system to avoid total extraction (holes for M4 screw at both ends – 10mm from the edge)

### MODIFICATIONS

- Add 4mm horizontal hole in both ends 10mm from the edge
- Source support blocks





## 4. TROLLEY ACCESSORY

- Brackets mounted wrong way.
- Bracket design too long in one side.

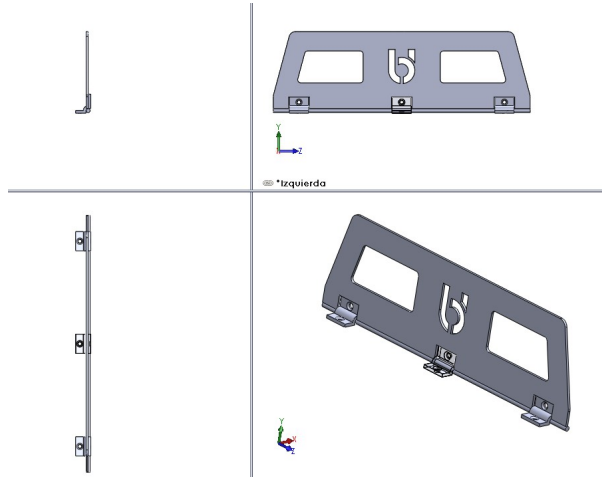

## MODIFICATIONS

- **Cut 6mm from the long side of the bracket**

